

AWSTL- S-Type Load Cell

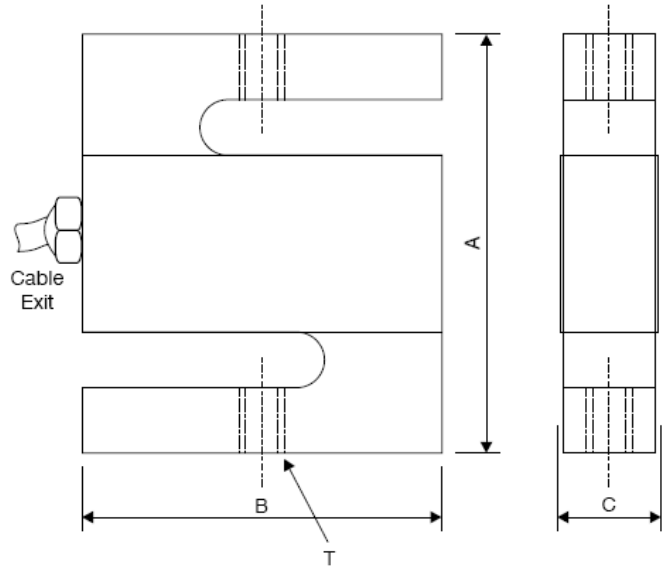

Capacity (kg)	A	B	C	T
100 -750kg	76.2	50.8	19.1	M12*1.75
1000kg	76.2	50.8	25.4	M12*1.75

Specifications

Capacity (kg)	100, 250, 500, 1000
Rated Output/RO (mV/V)	2 ± 0.01
Zero Balance (mV/V)	±1%
Non-Linearity (%RO)	0.025%
Hysteresis (%RO)	< 0.010%
Repeatability (%RO)	< 0.015%
Creep (%RO/30min)	< 0.023%
Temp effect on output (%RO/10°C)	< 0.015%
Temp effect on zero (%RO/10°C)	< 0.020%
Input Impedance (Ω)	400 +/- 30 Ω
Output Impedance (Ω)	350 +/- 5 Ω
Excitation +ve	Red
Excitation -ve	Black

Insulation (MΩ)	> 5000
Recommended Excitation (V)	5-12
Maximum Excitation (V)	18
Compensated Temp Range (°C)	-10~+50
Operating Temp Range (°C)	-20~+60
Safe Overload (%RO)	150
Ultimate Overload (%RO)	200
Cable Size (mm)	∅5 x 5000
Cable Length (m)	5
Material	Stainless Steel
Protection Class	IP67
Signal +ve	Green
Signal -ve	White