

AWLP Load Pin

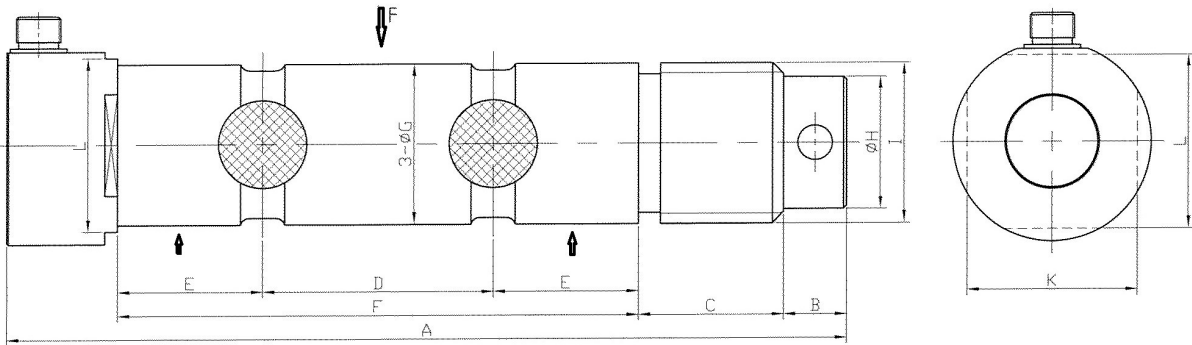

Options

- ◆ Weighing Indicator (Reader)
- ◆ Shackles
- ◆ Bobbins/ Sleeve
- ◆ Anti-rotation plate

Features

- ◆ Suitable for standard shackles
- ◆ Stainless steel Load pin
- ◆ IP67 Protection/ Sealing
- ◆ Easy Installation

Specifications

Capacity (t)	3, 5, 10, 25 & 55
Rated Output/RO (mV/V)	1.4 +/- 0.1
Zero Balance (mV/V)	± 1%
Non-Linearity (%RO)	1%
Hysteresis (%RO)	< 0.025%
Repeatability (%RO)	< 0.025%
Creep (%RO/30min)	< 0.023%
Temp effect on output (%RO/10°C)	< 0.020
Temp effect on zero (%RO/10°C)	< 0.025%
Input Impedance (Ω)	800 +/- 50 Ω
Output Impedance (Ω)	700 +/- 10 Ω

Insulation Resistance (MΩ)	> 5000
Recommended Excitation (V)	5-12
Maximum Excitation (V)	18
Compensated Temp Range (°C)	-10~+50
Operating Temp Range (°C)	-20~+60
Safe Overload (%RO)	120
Ultimate Overload (%RO)	200
Cable Size (mm)	Ø5mm x 10m long
Cable Length (m)	10
Material	Stainless Steel
Protection Class	IP67

Capacity (t)	A	B	C	D	E	F	G	H	I	J	K	L
3	115	10	16	27	16	59	19	13	3/4"-10UNC	36	25	26
5	142	10	23	36	22	80	25	19	1"- 8UNC	42	33	34
10	191	15	32	51	32	115	35	25	1-3/8"-6UNC	52	41	42
25	266	20	46	73	46	165	50.8	42	2"-4.5UNC	63	54	55
55	358	25	63	105	65	235	70	62	2-3/4"-4UNC	88	74	75